

# **Petro 3003**

## **Lühikasutusjuhend**

### **VOLUTANK**

(Ilma SAFE, koos täisvoolikuga, koos entresteniga, koos ettevõtte valikul)

Tarkvara versioon PYRAMIDE 2.5.x

KBA 210338

**PLEASE NOTE**

*This document is a short version of the product operation. It must be kept in the immediate vicinity of the device so that access to it is possible at any time.*

*To be observed safety and more detailed instructions, see the operation manual.*

*The current version can be downloaded from [www.bartec.de](http://www.bartec.de) or requested from BARTEC BENKE GmbH.*

# Laaditud ilma SAFE`ita

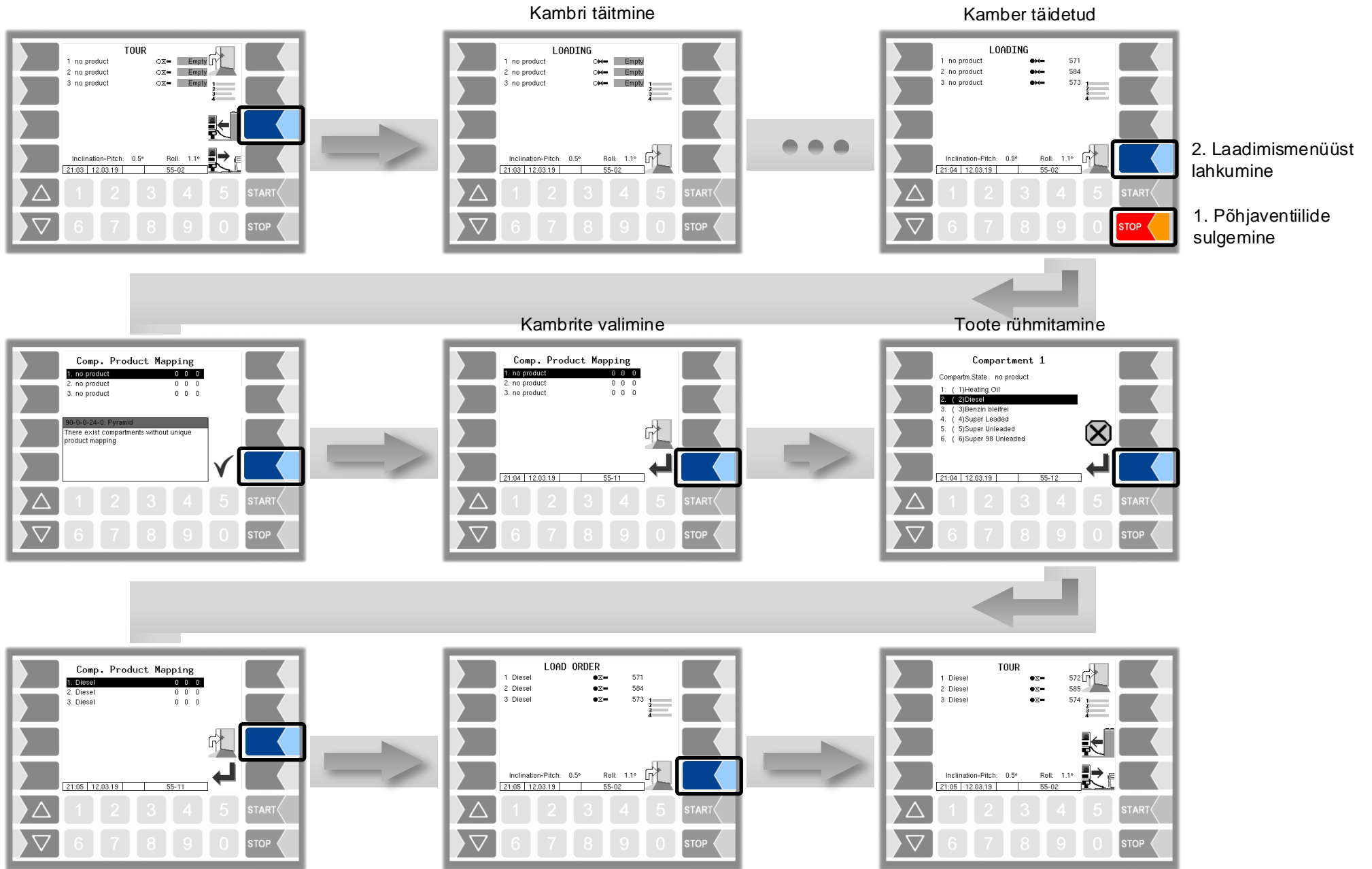

# Laaditud koos ettevõtte valikul

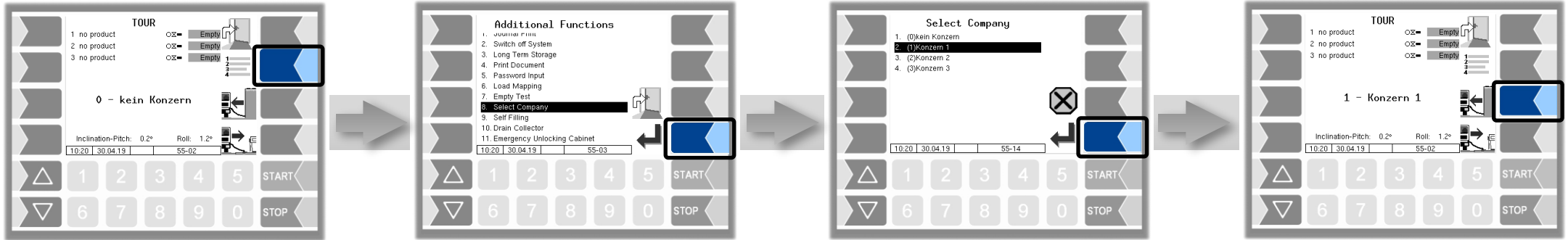

Kambri täitmine

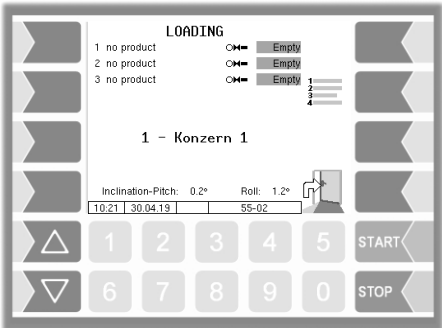

Kamber täidetud

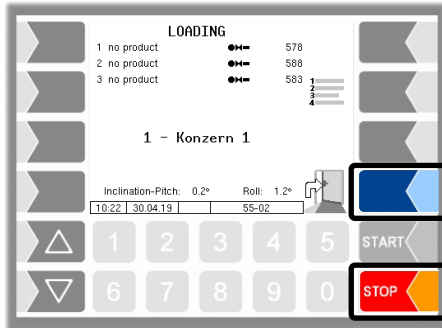

2. Laadimismenüüst lahkumine

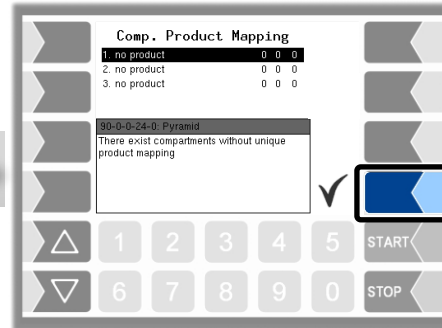

Kambrite valimine

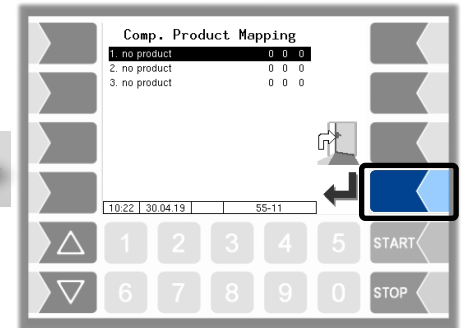

1. Põhjaveentide sulgemine

Toote rühmitamine

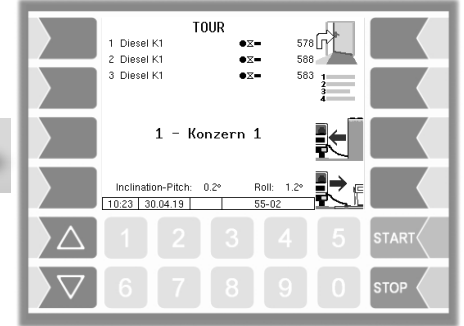
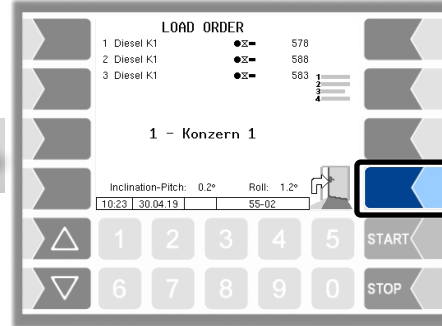
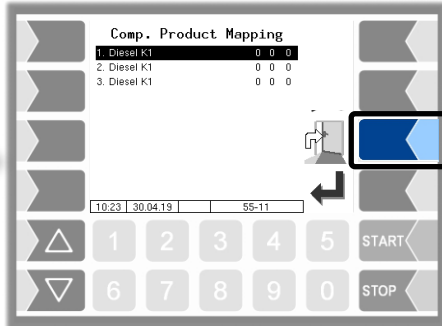
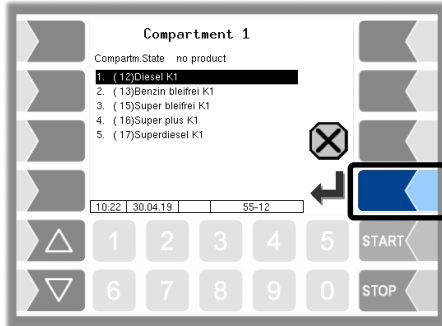

# Väljastamine ilma SAFE´ita



# Täisvooliku (tankimispüstol voolikuga) paralleelne väljastus

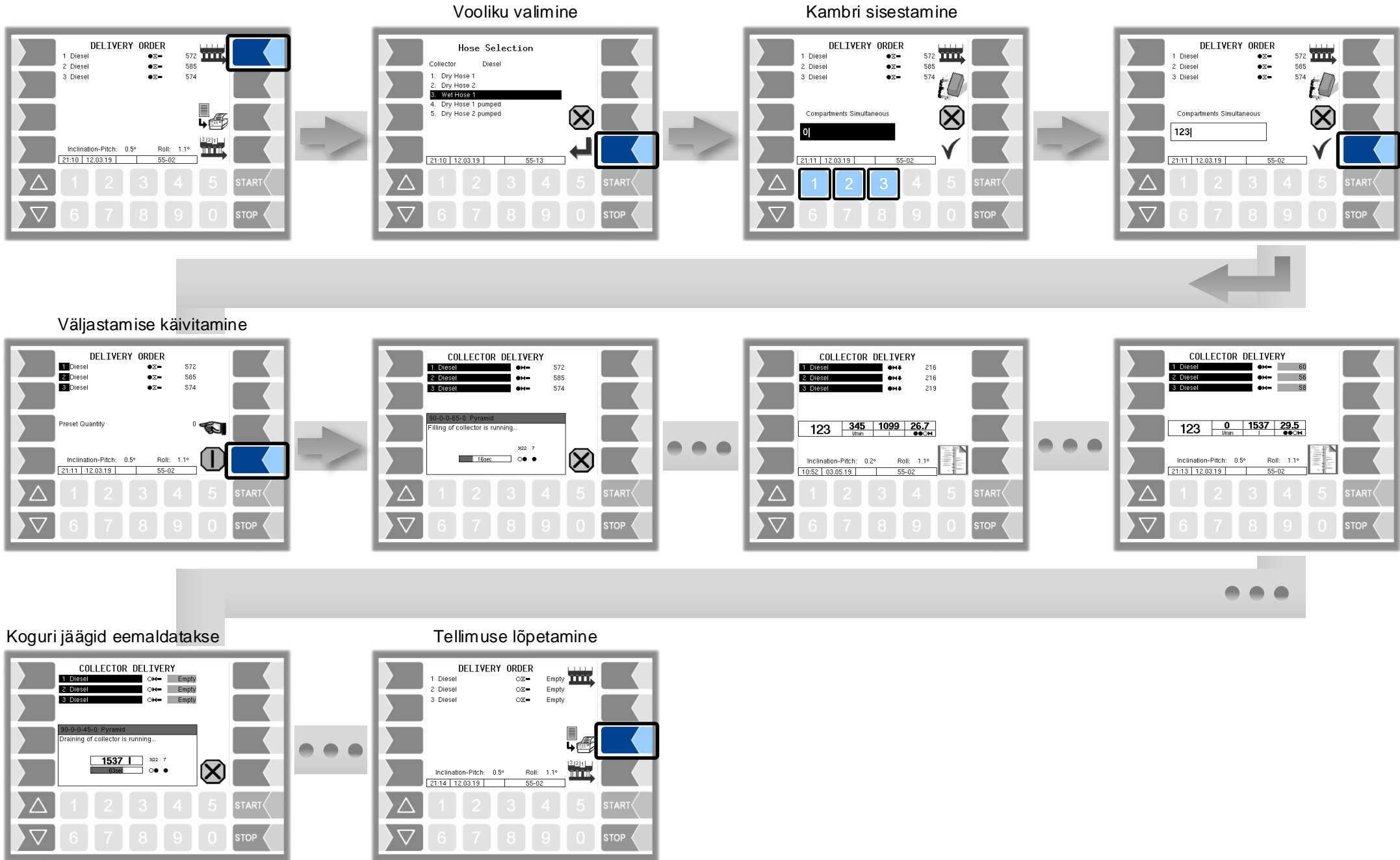

# Täisvooliku (tankimispüstol voolikuga) järjestikune väljastus

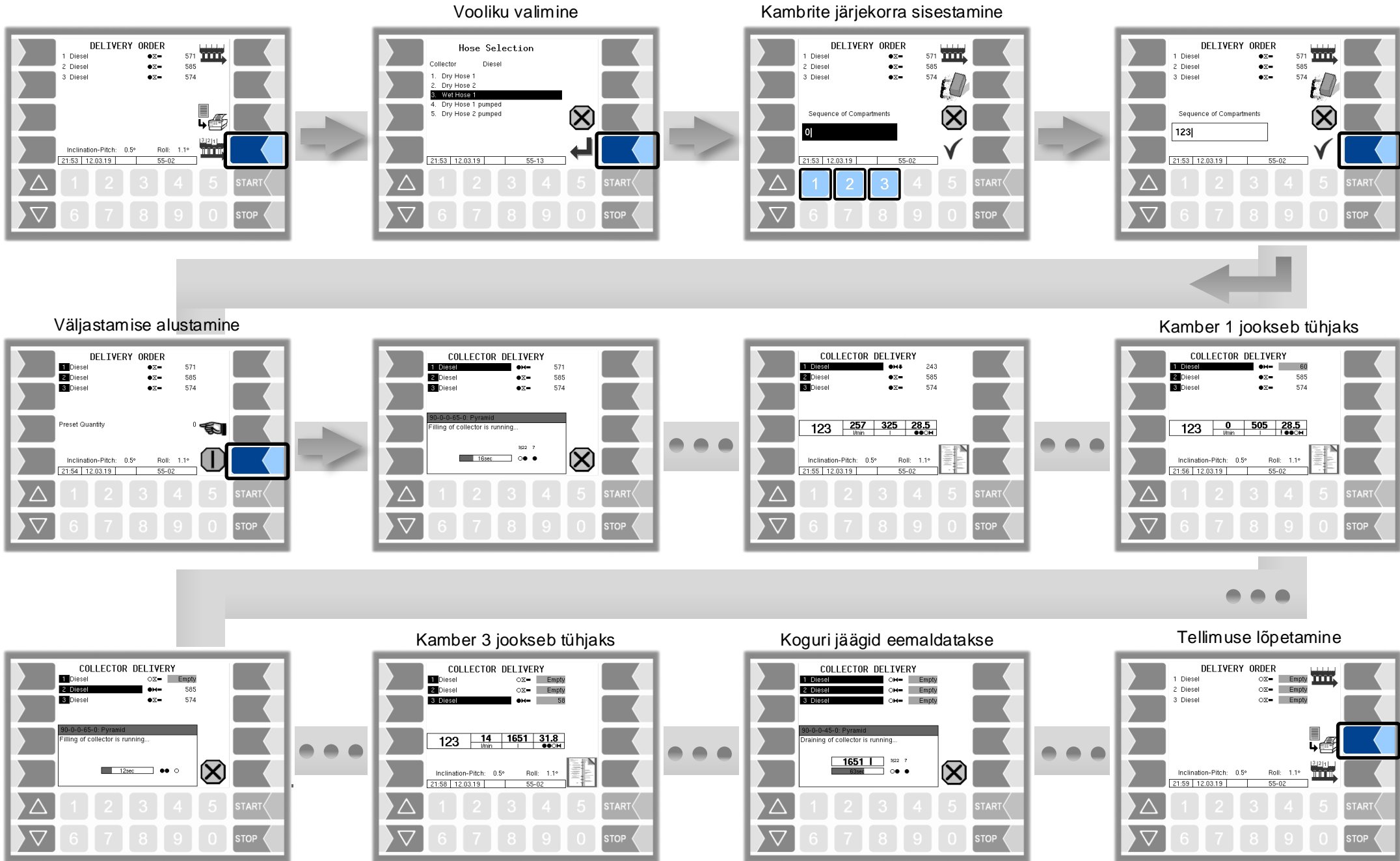

# Täisvooliku (tankimispüstol voolikuga) osaline väljastus

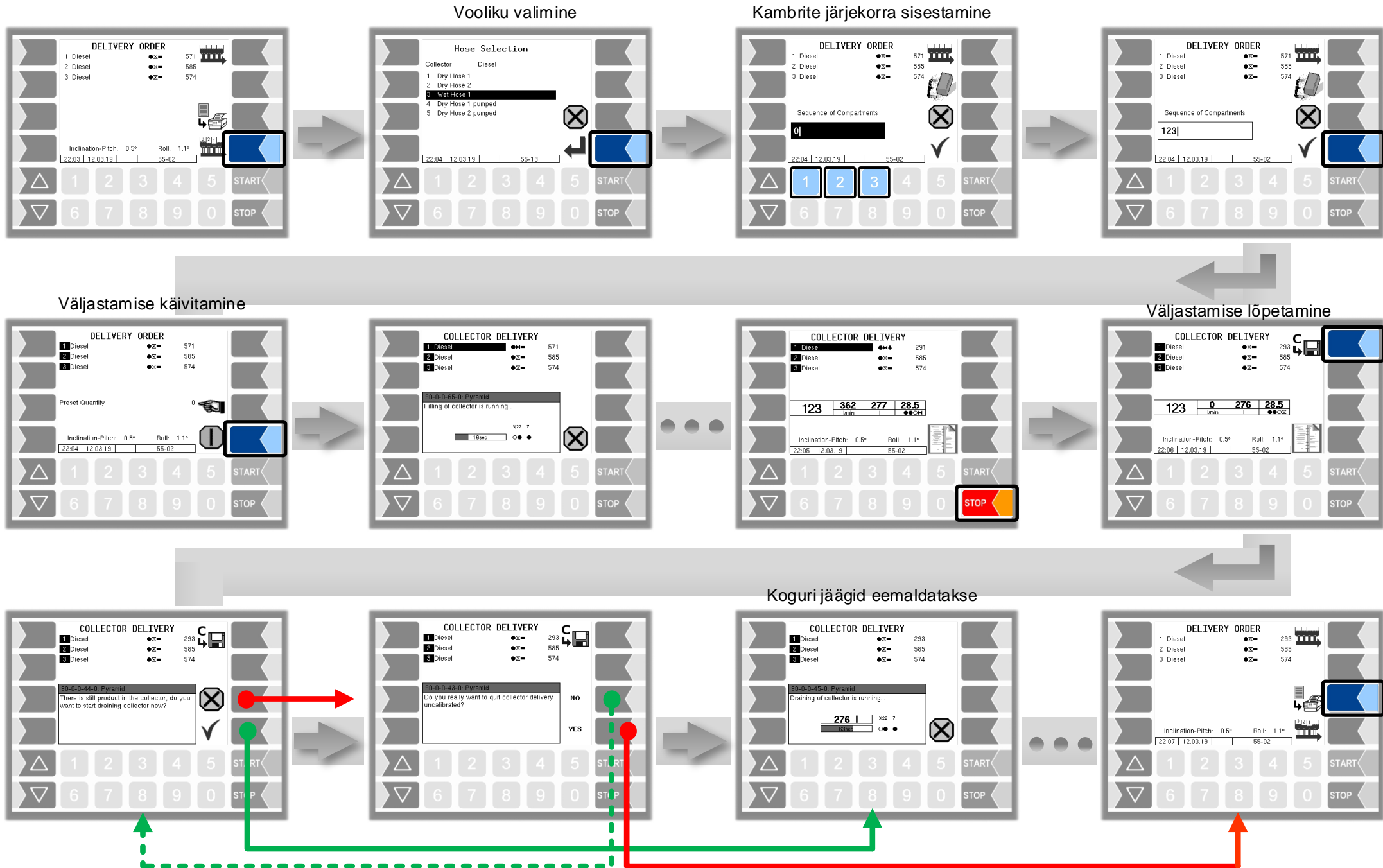



# Eemaldada jäägid kogurist

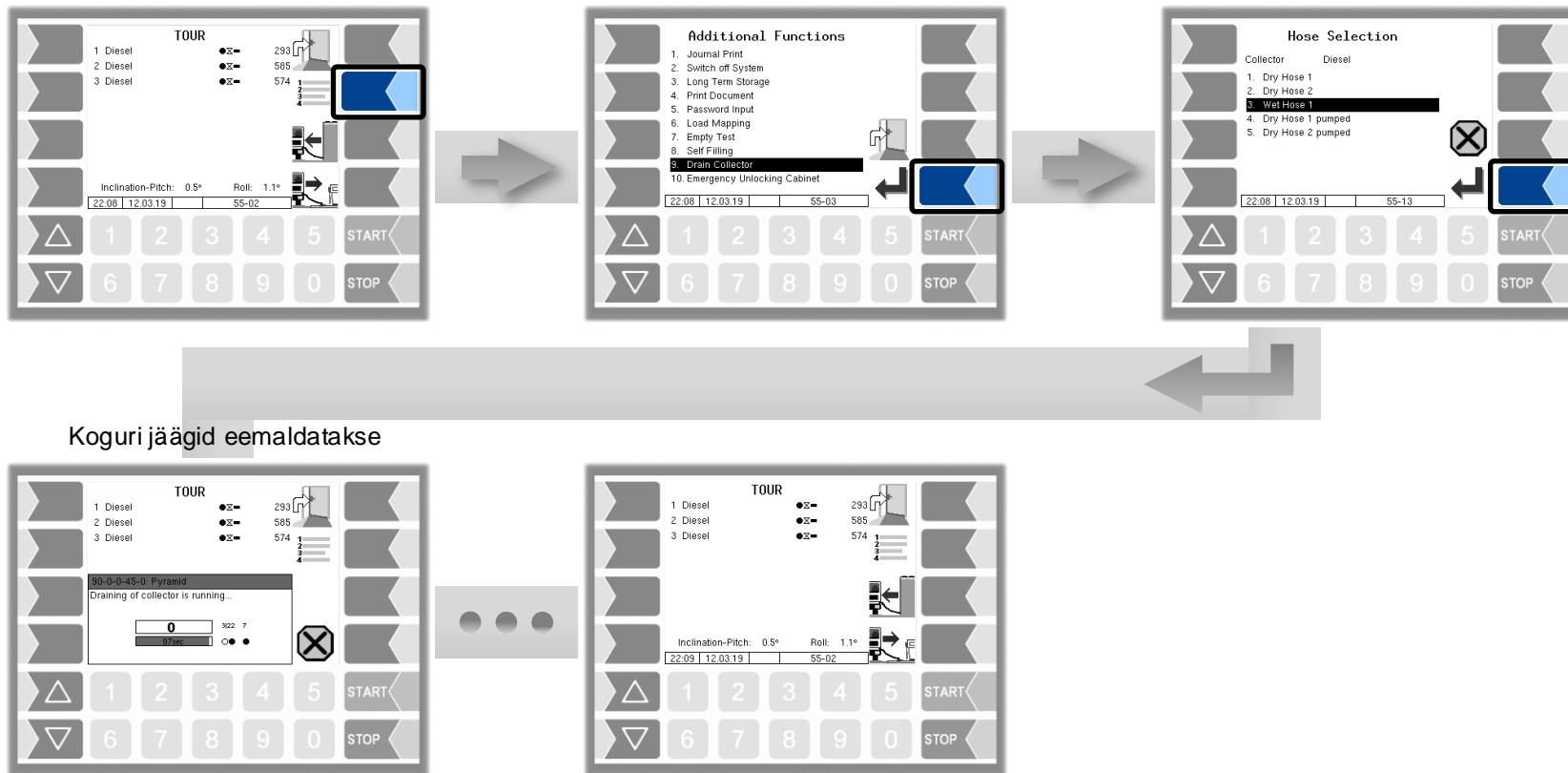

# Ülevaade töörežiimide näidikust

